

# Optimum T4200 Family

## TERMINAL INSTALLATION GUIDE

### COMPLIANCE

Changes or modifications not expressly approved by the party responsible for compliance could void the user's authority to operate the equipment.

- FCC Part 68 (pending)  
This device complies with Part 15 of the FCC Rules. Operation is subject to the following two conditions: (1) this device may not cause harmful interference, and (2) this device must accept any interference received, including interference that may cause undesired operation. The user is cautioned that changes or modifications to the product(s) identified in this manual unless expressly approved by Hypercom could void the user's authority to operate these product(s).
- IC CS-03 (pending)
- CE (pending)
- A-tick (pending)
- UL/CUL Listing (pending)



685 Cathcart Street, Suite 1000 • Montreal, QC, H3B 1M7  
Tel: 1 866 557-5553 • Fax: 1 866 438-5612  
www.pivotalpayments.ca

TIG0608

© 2008 Pivotal Payments, all rights reserved. Hypercom and Optimum and Design are registered trademarks of Hypercom Corporation. The Hypercom Logo is a trademark of Hypercom Corporation. All other products or services mentioned in this document are trademarks, service marks, registered trademarks or registered service marks of their respective owners.



# Optimum T4200 Family

## TERMINAL INSTALLATION GUIDE



www.pivotalpayments.ca

# Optimum T4200 Family Terminal Installation Guide

## Equipment Check List →



### WARNING:

- Do not use if visibly damaged.
- Do not expose to temperatures above 140 °F or 60 °C.
- Do not disassemble.
- Do not incinerate or crush.
- Keep out of reach of children and pets.



Optimum  
T4200 Family

Paper  
Roll



A/C Power Adapter



RJ11 Cable  
(Telephone Cable)



Power Cord

The *Optimum T4200 Family Terminal Installation Guide* provides basic setup information to any device within the Optimum T4200 Family.

Note: Images within this guide may not exactly match your device.

## Power & Cable Connections



1  
Wiring Clip  
Turn the terminal over. With your fingers, remove the wiring clip from the back of the terminal (as shown).



2  
Labeled Ports  
Labeled ports on the back are defined as:  
- LINE port = RJ11 (telephone) cable  
- POWER port = A/C Power Adapter & Power Cord  
- SERIAL port = RS232 cable  
- PIN PAD port = PIN pad cable  
- NET port = Ethernet cable



3  
POWER Port  
Connect Power Cord to A/C Power Adapter. Insert A/C Power Adapter into POWER port (as shown). Turn connector counterclockwise, toward back of the terminal, to lock in place. Insert other end of the Power Cord into the wall receptacle.



4  
LINE Port  
Insert RJ11 cable into LINE port (as shown).



5  
NET Port  
Insert Ethernet cable into NET port (as shown). Note: Bend the cable 90° at the base of the connector.

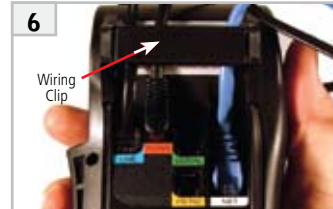

6  
Wiring Clip  
With your fingers, re-insert the wiring clip over the cables (as shown).

## Receipt Paper Installation



1  
Printer Cover  
With your fingers, open the printer cover (as shown).

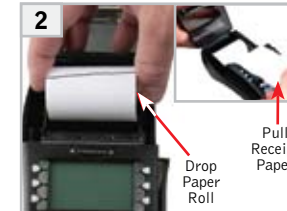

2  
Drop Paper Roll  
Pull Receipt Paper  
Drop paper roll into paper holder (as shown). Pull paper (as shown) & close printer cover.



3  
Paper Receipt Guide  
Pull & tear paper against the paper receipt guide. Operate terminal as normal.

## Swiping Your Credit Card Inserting Your Smart Card



1  
Credit Card  
Bi-directional Card Reader  
Swipe credit card through the card reader with a downward or upward motion (as shown).



1  
Smart Card Reader  
Smart Card  
Insert smart card (gold chip side up) into the smart card reader (as shown).

## Accessories Available



Optimum T4210  
(P/N# 010332-xxx)



Optimum T4220  
(P/N# 010332-xxx)



Optimum T4230  
(P/N# 010332-xxx)



Paper Roll  
(P/N# 710015-003)



A/C Power Adapter  
(P/N# 870065-002)



Power Cord  
(P/N# Based on Region)



RJ11 Cable  
(Telephone Cable)  
(P/N# 810005-010)